



مصنع سهيل للمصبوبات المعدنية
SUHAIL METAL CASTINGS FACTORY



PIPE FITTINGS & MANHOLE COVERS
CATALOGUE

INDEX



ABOUT US
WHAT WE DO
VISION AND MISSION
ENGINEERING CAPABILITIES
MANUFACTURING CAPABILITIES

MATERIAL SELECTION
PRODUCT AT A GLANCE
PRODUCT SPECIFICATION
MARKING
GENERAL SPECIFICATION

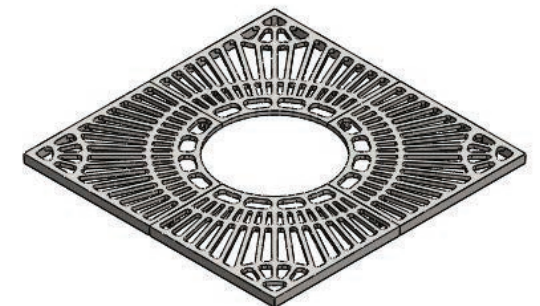
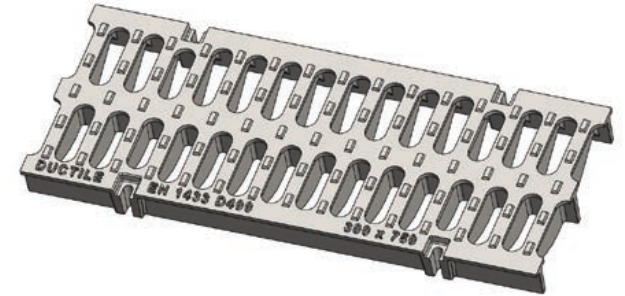
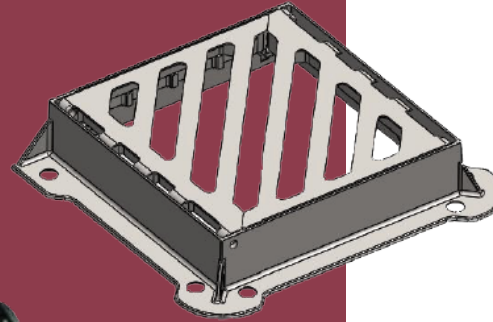

ABOUT US

As the first metal casting foundry in the State of Qatar, Suhail Factory for Metal Castings was built in the city of Mesaieed in 2022. It has two facilities that adopt the advanced technology in two different methods of metal casting. The first facility is a state-of-the-art sand-casting foundry using European technology, while the second facility is an investment - casting that uses robots to ensure consistent quality.

This facility is capable to manufacture pipeline products and accessories like pipe fittings, universal couplings, Socket fittings, flanged adaptors, restrained adaptors, dismantling joints, clamps, valves, fire hydrants, etc. Suhail Metal Castings Factory regards quality as an essential and integral part of our business success. We are working with ISO 9001, ISO 14001, ISO 45001, BSI Kitemark symbols.

FACILITY GENERAL INFORMATION

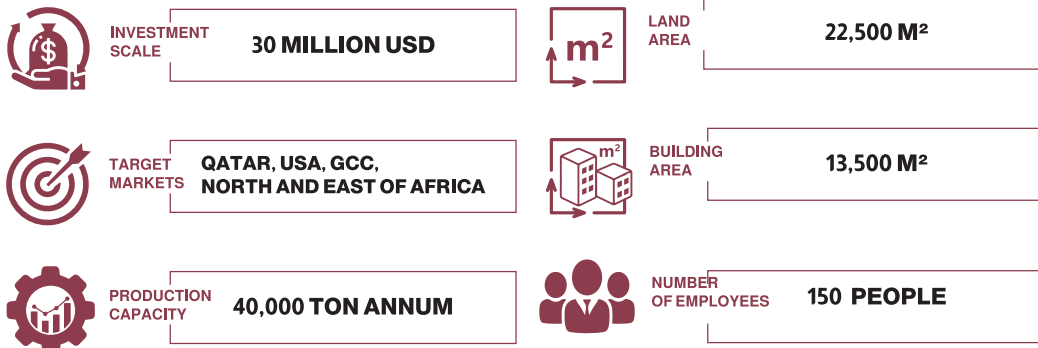

WHO WE ARE

Suhail Factory for Metal Casting, is an advanced foundry which comprise of green sand molding lines and investment casting facility with robotic shelling system. Producing cast iron/steel/non-ferrous castings for engineering, automobile, oil and gas field.

WHAT WE DO

- The green sand-casting foundry at **SUHAIL METAL CASTINGS FACTORY**, metal is melted in either of three induction furnaces then molten metal is poured into sand molds that are formed using forming machines that mix sand materials, fill and press them onto patterns bearing the shape of the final product.
- On the other hand, at the Investment Casting Facility, the patterns are shaped using wax injection machines, then the patterns are assembled and moved to the robotic shelling system where the shells are automatically prepared before moving them to dewaxing then shell firing and finally to metal pouring area.

Covering an area of 22,500 m², SFMC is capable to produce up to 40,000 Tons/ Annum of :

- Engineering Castings
- Automobile Cast Parts
- Oil and Gas Castings



COUNTRIES OF EXPORTS

SELLING TO 5 CONTINENTS, INCLUDING AND NOT LIMITED TO:

- 📍 **QATAR**
- 📍 **USA**
- 📍 **OMAN**
- 📍 **KUWAIT**
- 📍 **EUROPE**
- 📍 **NORTH AND EAST OF AFRICA**

With its production methods and R&D studies using advanced technologies such as 3D Sand & Metal printing, SFMC is one of the few manufacturers in the world using such technologies, giving SFMC an edge over other metal casting foundries in the region.

VISION

To be a leading local manufacturer and dependable partner for our clients, offering engineered goods and solutions.



MISSION

Supporting Qatar's social and economic development.

- Improve local content by transferring technologies and developing human capital.
- Assist in the development of oil and gas, water, and other prospective industrial projects.

Proactively involved with our major stakeholders.

- Taking care of our people, our community, and the environment.
- Focus on operational excellence in engineered product manufacture.

ENGINEERING CAPABILITIES

- Research and development.
- 3D Modeling (Solidworks, Creo).
- Design analysis and optimization (ANSYS)
- Reverse Engineering (3D scanning-FARO).
- Prototype (3D Voxeljet Sand printing)
- Casting Solidification Simulation (Nova Cast)
- Patterns and Tool making (Master CAM, CNC Router, CNC Machining).
- Dimensional Analysis. (CMM, FARO)
- Metal and plastic 3D printing machines (MAPTEC)



 NOVACAST

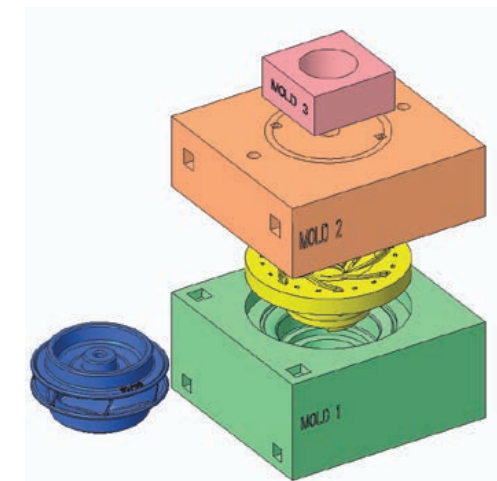
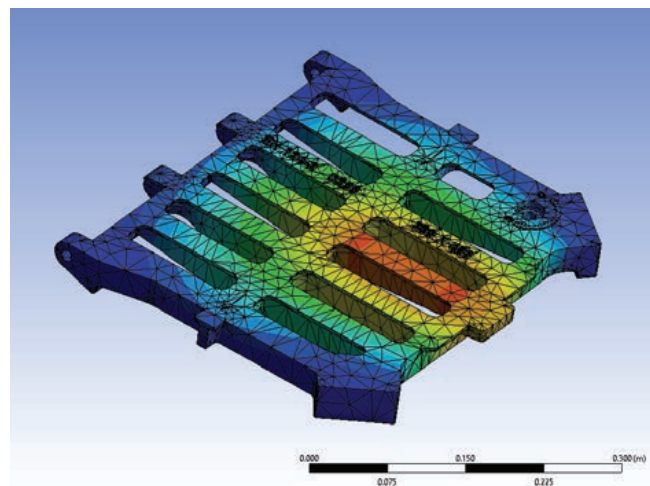
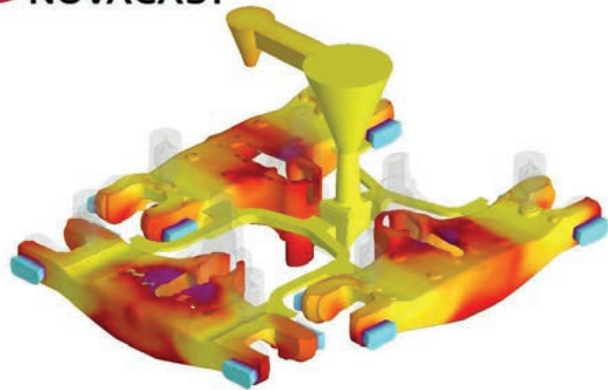

MANUFACTURING CAPABILITIES

1. Green Sand Foundry

- Sand plant. (DISA)
- Automatic DISA Flex Machine (60 molds / hour)
- Two DISA ARPA 1300 Jolt Squeeze machines (30 molds /hour)
- DISA shot blasting machine.



- **OMEGA core shooters**

- Three Continuous mixer 3 tons / hour capacity.
- Three Machines with Shot weight ranging from 12 to 100 kg.

CAPABILITIES



- **Induction Melting IFurnaces**
 - Three furnaces with 3 tons capacity.
 - Melt rate of 6 tons / hour
- **Two Automatic Metal pouring systems.**

- **Automatic coating line.**

- 55 parts / hour
- Phosphating
- Prime coating
- Top coating

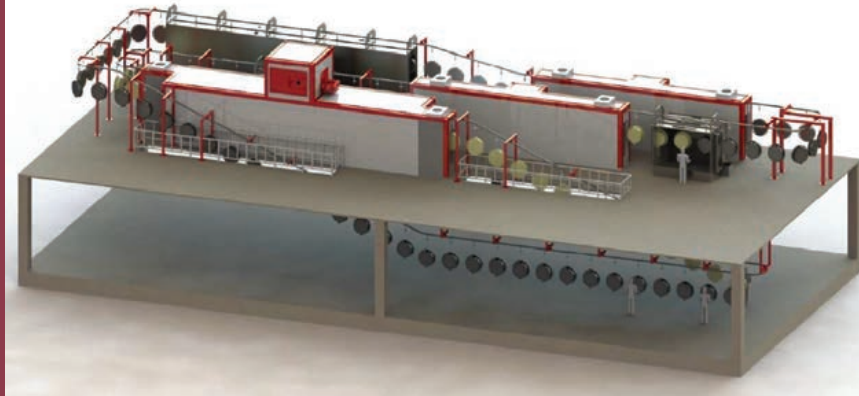

2. Investment casting

- Investment plant capacity 80 Tons / month.
- Automatic Robotic Shelling System.
 - Capacity - 200 Shells per day.
- Five Wax Injection machines.
- Dewaxing Machine.
- Three Melting Furnaces.
- Firing Furnaces.
- Heat Treatment Plant.

CAPABILITIES

- Advanced sand testing Laboratory.
- Metallurgical testing laboratory (Thermal Analysis, Spectrographic Analysis and Metallographic analysis with image Analyzer).



- Mechanical Testing Laboratory

- UTM,
- Hardness testing and
- Manhole cover Load Testing

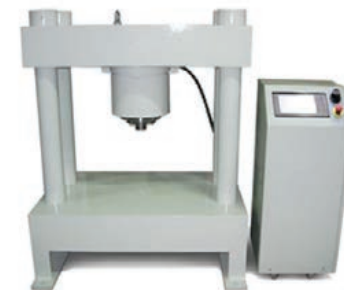

CERTIFICATIONS



MATERIAL SELECTION

Suhail metal casting manufacture a range of high-performance cast-iron products including manhole covers/gully tops and DI Pipe Fittings. We recognize the need to provide a material that is capable of combating the wear characteristics inherent with the increasing amount of vehicular traffic on our roads today.

THE DIFFERENCE BETWEEN DUCTILE AND GREY IRON

The addition of magnesium at the molten stage transforms the flakes of graphite, which are common with the grey iron casting process, into spheroidal or nodular form. The spheroidal structure provides a higher tensile strength as well as a higher 'Strength to weight' ratio when compared with the properties inherent with grey.

THE ADVANTAGE OF DUCTILE IRON

Ductile iron used for pipe fittings and accessories in which graphite is present primarily in Spheroid form. The addition of magnesium at the molten stage which transforms the flake graphite into spheroidal graphite. The Spheroidal structure provides a higher tensile strength as well as a higher 'Strength to weight' ration when compared with the properties inherent with grey. Other excellent properties such as anti-high compression, anti-oxidation, anti-corrosion etc. So, the ductile iron pipe fittings are widely used to such compressive pipes as water pipelines, sewage pipeline, etc.

Ductile Iron pipe fittings manufactured with ASTM A536: 65-45-1 grade

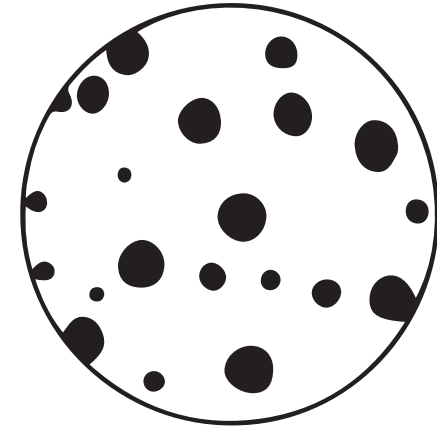

Ductile / Spheroidal Iron

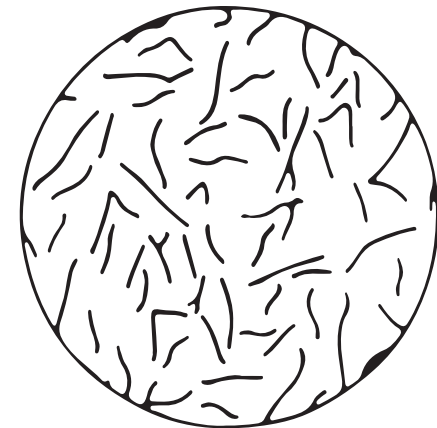

Grey Cast Iron



PRODUCT AT A GLANCE

DI PIPE FITTINGS & ACCESSORIES

This Technical profile describes about ductile iron pipe fittings accessories and their joints for the pipeline or sewage application.

To convey water line application.

To convey sewage application.

TECHNICAL DESCRIPTION

Pipe fittings are used to join pipes together to transfer the water in the pipelines with pressure or without pressure. Fittings are manufactured within all required specification and all our well-established foundry quality standards and delivered as per customer requirements.

It is applicable to pipe fittings manufactured with socket type and flanged type fittings.

Process control activities such as metallurgical control, measuring dimensions and tolerances, checking mechanical properties, material leak tightness test for water pipeline application and sewage application shall be carried out on all fitting according to specifications before the application of their external and internal coatings.



EN545 FLANGED FITTINGS

FLANGE DIMENSIONS

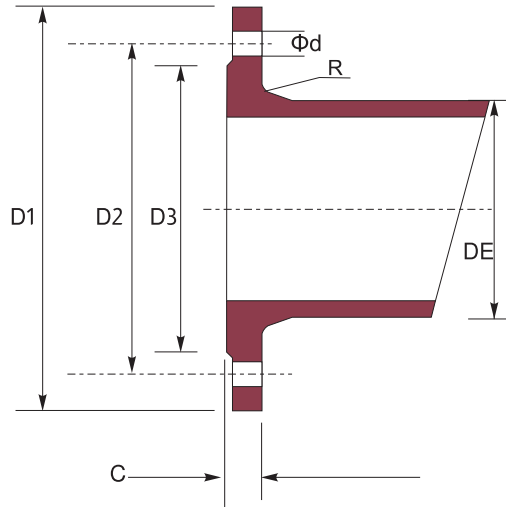

FLANGE PN 16

Dimensions in mm

Nominal Dia DN	D1	D2	D3	DE	C	R	Bolts		
							Φd	Size	Nos.
80	200	160	132	98	19.0	6	19	M16	8
100	220	180	156	118	19.0	6	19	M16	8
150	285	240	211	170	19.0	8	23	M20	8
200	340	295	266	222	20.0	8	23	M20	12
250	400	355	319	274	22.0	10	28	M24	12
300	455	410	370	326	24.5	10	28	M24	12
350	520	470	429	378	26.5	10	28	M24	16
400	580	525	480	429	28.0	10	31	M27	16
450	640	585	548	480	30.0	12	31	M27	20
500	715	650	609	532	31.5	12	34	M30	20
600	840	770	720	635	36.0	12	37	M33	20

Flange dimensions to EN1092-2 / ISO 7005-2

FLANGE PN 10

Dimensions in mm

Nominal Dia DN	D1	D2	D3	DE	C	R	Bolts		
							Φd	Size	Nos.
80	200	160	132	98	19.0	6	19	M16	8
100	220	180	156	118	19.0	6	19	M16	8
150	285	240	211	170	19.0	8	23	M20	8
200	340	295	266	222	20.0	8	23	M20	8
250	400	350	319	274	22.0	10	23	M20	12
300	455	400	370	326	24.5	10	23	M20	12
350	505	460	429	378	24.5	10	23	M20	16
400	565	515	480	429	24.5	10	28	M24	16
450	615	565	530	480	24.5	12	28	M24	20
500	670	620	582	532	26.5	12	28	M24	20
600	780	725	682	635	30.0	12	31	M27	20

FLANGE PN 25

Dimensions in mm

Nominal Dia DN	D1	D2	D3	DE	C	R	Bolts		
							Φd	Size	Nos.
80	200	160	132	98	19.0	6	19	M16	8
100	235	190	156	118	19.0	6	23	M20	8
150	300	250	211	170	20.0	8	28	M24	8
200	360	310	274	222	22.0	8	28	M24	12
250	425	370	330	274	24.5	10	31	M27	12
300	485	430	389	326	27.5	10	31	M27	16
350	555	490	448	378	30.0	10	34	M30	16
400	620	550	503	429	32.0	10	37	M33	16
450	670	600	548	480	34.5	12	37	M33	20
500	730	660	609	532	36.5	12	37	M33	20
600	845	770	720	635	42.0	12	40	M36	20

EN545 FLANGED FITTINGS

DOUBLE FLANGED
90° BEND

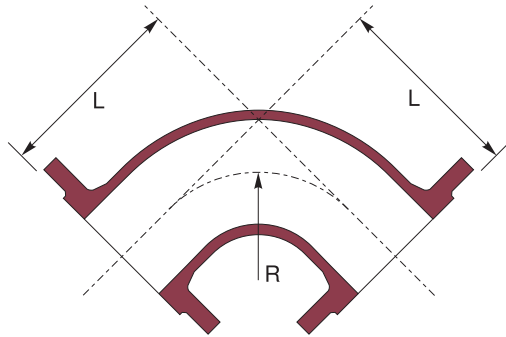

DN	L	Unit Wt. Kgs. PN10	Unit Wt. Kgs. PN16	Unit Wt. Kgs. PN25
50	150	6.0	6.0	6.0
65	165	7.0	7.0	7.0
80	165	9.6	9.6	9.6
100	180	15.6	15.6	15.6
150	220	20.5	20.5	20.5
200	260	31.0	31.0	35.0
250	350	49.5	49.5	56.7
300	400	69.5	69.5	80.3
350	450	90.6	96.0	111.8
400	500	117.0	126.0	148.0
450	550	147.2	163.0	184.8
500	600	184.2	211.0	232.2
600	700	276.6	324.0	347.6

DOUBLE FLANGED
45° BEND

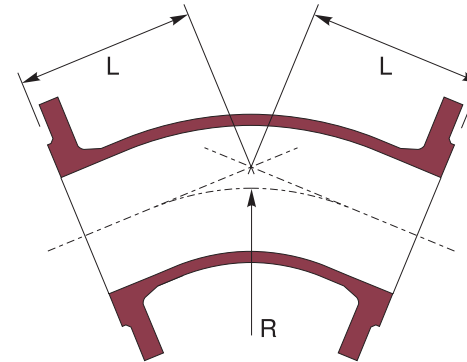

DN	L	Unit Wt. Kgs. PN10	Unit Wt. Kgs. PN16	Unit Wt. Kgs. PN25
50	150	5.0	5.0	5.0
65	165	7.0	7.0	7.0
80	130	9.3	9.3	9.3
100	140	11.4	11.4	11.4
125	150	14.6	14.6	14.6
150	160	18.9	18.9	18.9
200	180	27.5	27.5	31.5
250	350	54.5	54.5	61.7
300	400	76.5	76.5	87.3
350	298	77.1	82.5	98.3
400	324	98.0	107.0	129.0
450	349	119.2	135.0	156.8
500	375	148.2	175.0	196.2
600	426	215.6	263.0	286.6

EN545 FLANGED FITTINGS

DOUBLE FLANGED
22.5° BEND

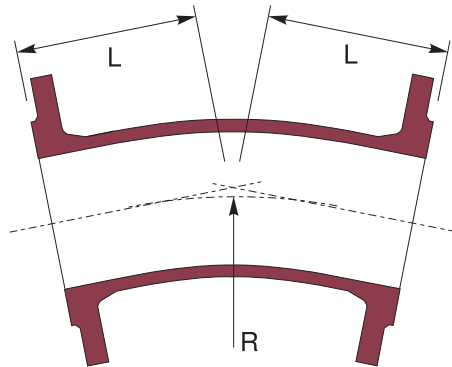

DN	L	Unit Wt. Kgs. PN10	Unit Wt. Kgs. PN16	Unit Wt. Kgs. PN25
80	130	9.2	9.2	9.2
100	140	11.5	11.5	11.5
125	150	16.0	16.0	16.0
150	160	18.6	18.6	18.6
200	180	27.0	27.0	31.0
250	350	54.5	54.5	61.7
300	400	77.5	77.5	88.3
350	298	77.6	83.0	98.8
400	324	98.0	107.0	129.0
450	349	119.2	135.0	156.8
500	375	149.2	176.0	197.2
600	426	219.6	267.0	290.6

DOUBLE FLANGED
11.25° BEND

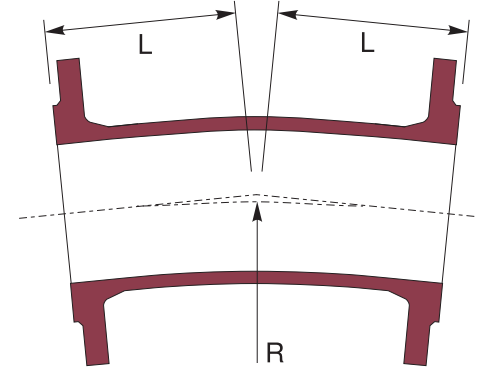

DN	L	Unit Wt. Kgs. PN10	Unit Wt. Kgs. PN16	Unit Wt. Kgs. PN25
80	130	9.2	9.2	9.2
100	140	11.5	11.5	11.5
125	150	16.0	16.0	16.0
150	160	18.6	18.6	18.6
200	180	27.0	27.0	31.0
250	350	55.0	55.0	62.2
300	400	78.0	78.0	88.8
350	298	78.1	83.5	99.3
400	324	99.0	108.0	130.0
450	349	119.2	135.0	156.8
500	375	148.2	175.0	196.2
600	426	220.6	268.0	291.6

EN545 FLANGED FITTINGS

DOUBLE
FLANGED
90° LONG
RADIUS BEND

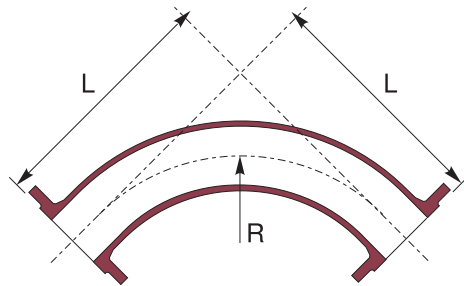

DN	L	Unit Wt. Kgs.		
		PN10	PN16	PN25
80	380	13.8	13.8	13.8
100	400	18.0	18.0	18.0
150	450	30.0	30.0	30.0
200	500	45.5	45.5	49.5
250	550	65.0	65.0	72.2
300	600	89.5	89.5	100.3
350	650	115.6	121.0	136.8
400	700	148.0	157.0	179.0
450	750	181.2	197.0	218.8
500	800	225.2	252.0	273.2
600	900	331.6	379.0	402.6

DOUBLE
FLANGED
90° DUCKFOOT
BEND

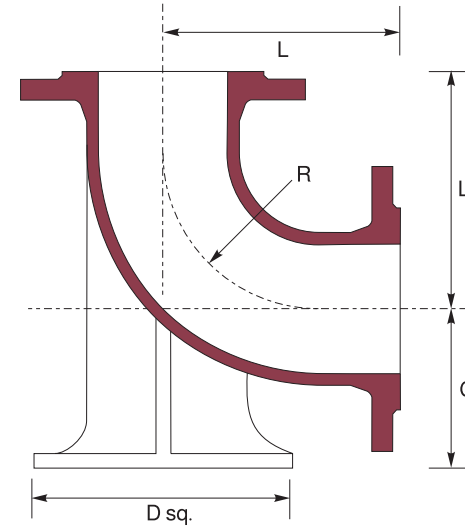

DN	L	C	D	Unit Wt. Kgs.		
				PN10	PN16	PN25
50	150	95	150	8.6	8.6	8.6
80	165	110	180	14.1	14.1	14.1
100	180	125	200	17.8	17.8	18.8
150	220	160	250	30	30	32
200	260	190	300	46.5	46	50.5
250	350	225	350	75	75	82
300	400	255	400	106	105	116
350	450	290	450	139	145	162
400	500	320	500	178	189	212
450	550	355	550	229	249	275
500	600	385	600	283	313	337
600	700	450	700	428	481	509

All dimensions are in mm

EN545 FLANGED FITTINGS

ALL FLANGED TEE

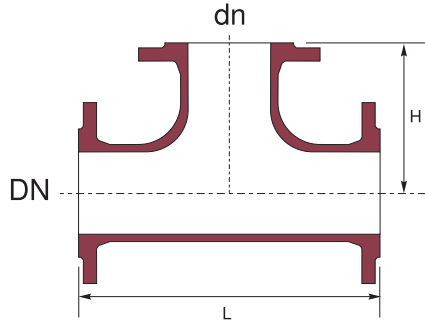

DN	dn	L	H	Unit Wt. Kgs. PN10	Unit Wt. Kgs. PN16	Unit Wt. Kgs. PN25
80	80	330	165	15.6	15.6	15.6
100	80	360	175	18.4	18.4	18.4
	100	360	180	19.4	19.4	19.4
150	80	440	205	28.5	28.5	31
	100	440	210	29.5	29.5	32
	150	440	220	32.5	32.5	36
200	80	520	235	42	41.5	46
	100	520	240	43	42	47.5
	150	520	250	46	45	51
	200	520	260	49.5	49	56
250	80	700	265	49.7	49.3	56.7
	100	700	275	68	67	75
	150	700	300	72	71	81
	200	700	325	76	75	85
	250	700	350	82	81	93
300	100	800	300	94	93	105
	150	800	325	98	97	109
	200	800	350	102	101	114
	250	800	375	109	108	121
	300	800	400	116	115	131

DN	dn	L	H	Unit Wt. Kgs. PN10	Unit Wt. Kgs. PN16	Unit Wt. Kgs. PN25
350	100	850	325	116	122	139
	150	850	325	119	125	142
	200	850	325	121	128	146
	250	850	352	128	134	154
	300	850	425	132	138	160
	350	850	425	142	151	176
400	100	900	350	143	154	177
	150	900	350	144	156	181
	200	900	350	148	159	184
	250	900	350	151	161	198
	300	900	450	160	184	213
	350	900	450	170	183	215
	400	900	450	174	191	215
450	100	950	375	176	193	225
	150	950	375	182	199	231
	200	950	375	190	207	240
	250	950	375	199	216	250
	300	950	475	210	227	263
	350	950	475	219	240	279
	400	950	475	231	254	296
	450	950	475	243	269	315
500	100	1000	400	210	241	265
	150	1000	400	214	243	269
	200	1000	400	215	245	271
	250	1000	400	218	258	280
	300	1000	500	227	255	287
	350	1000	500	239	262	298
	400	1000	500	242	276	311
	450	1000	500	249	298	327
	500	1000	500	252	297	332
600	100	1100	450	268	329	352
	150	1100	450	283	340	370
	200	1100	450	305	358	388
	250	1100	450	307	360	392
	300	1100	550	312	374	398
	350	1100	550	326	380	413
	400	1100	550	329	387	427
	450	1100	550	338	417	448
	500	1100	550	349	420	464
	600	1100	550	355	434	477

EN545 FLANGED FITTINGS

ALL FLANGED
45° ANGLE BRANCH

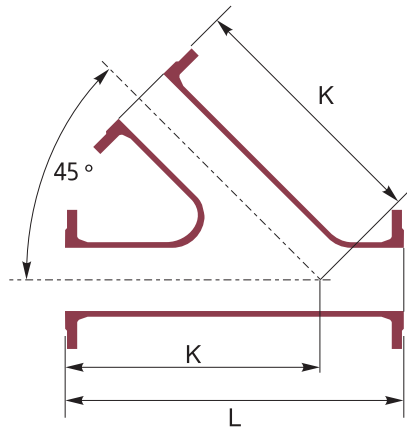

DN	L	K	Unit Wt. Kgs. PN10	Unit Wt. Kgs. PN16	Unit Wt. Kgs. PN25
80	500	375	21.0	21.0	21.0
100	540	405	27.0	27.0	27.0
150	640	480	47.0	47.0	47.0
200	735	560	71.0	71.0	77.0
250	830	640	105.0	105.0	115.8
300	930	715	147.0	147.0	163.2
350	880	790	177.0	188.0	213.0
400	970	870	238.0	255.0	288.0
450	1060	950	295.0	321.0	367.0
500	1140	1025	369.0	414.0	449.0
600	1310	1180	545.0	625.0	667.0

ALL FLANGED
TRUE WYE

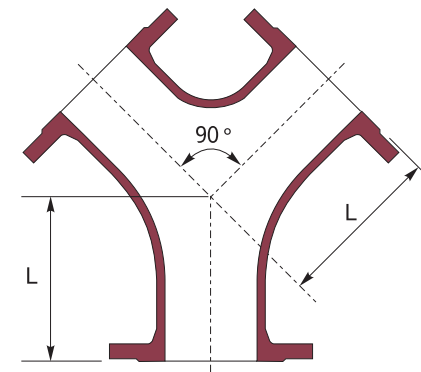

DN	L	Unit Wt. Kgs. PN10	Unit Wt. Kgs. PN16	Unit Wt. Kgs. PN25
80	165	15.6	15.6	15.6
100	180	19.3	19.3	19.3
150	220	32.5	32.5	32.5
200	260	49.0	49.0	55.0
250	350	81.0	81.0	91.8
300	400	115.0	115.0	131.2
350	450	157.9	166.0	189.7
400	500	231.0		
450	550	295.0		
500	600	385.0		
600	700	591.0		

EN545 FLANGED FITTINGS

ALL FLANGED RADIAL TEE

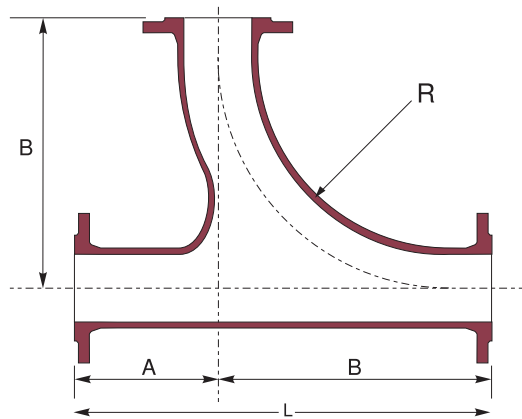

ALL FLANGED CROSS

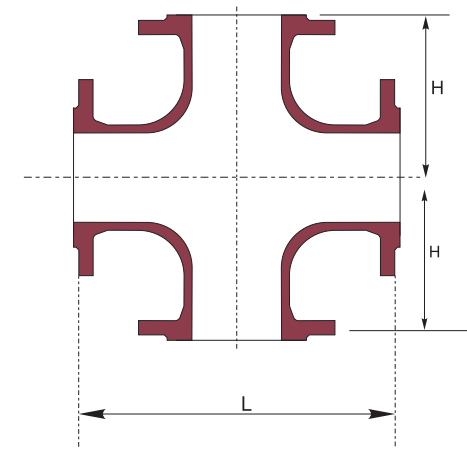

DN	L	A	B	r	Unit Wt. Kgs. PN10	Unit Wt. Kgs. PN16	Unit Wt. Kgs. PN25
80	545	165	380	330	23.0	23.0	23.0
100	580	180	400	340	29.5	29.5	29.5
150	670	220	450	385	48.5	48.5	48.5
200	760	260	500	430	72.5	72.5	78.5
250	900	350	550	475	106.0	106.0	116.8
300	1000	400	600	515	146.0	146.0	162.2
350	1100	450	650	560	195.9	204.0	227.7
400	1200	500	700	605	250.5	264.0	297.0
450	1300	550	750	650	308.3	332.0	364.7
500	1400	600	800	690	392.8	433.0	464.8
600	1600	700	900	780	561.9	633.0	668.4

DN	L	H	Unit Wt. Kgs. PN10	Unit Wt. Kgs. PN16	Unit Wt. Kgs. PN25
80	330	165	20.5	20.5	20.5
100	360	180	24.5	24.5	24.5
150	440	220	41.0	41.0	41.0
200	520	260	60.5	60.5	68.5
250	700	350	99.5	99.5	113.9
300	800	400	143.0	143.0	164.6
350	850	425	178.2	189.0	220.6
400	900	450	218.0	236.0	280.0
450	950	475	254.4	286.0	329.6
500	1000	500	316.4	370.0	412.4
600	1100	550	447.2	542.0	589.2

EN545 FLANGED FITTINGS

FLANGED
BELLMOUTH

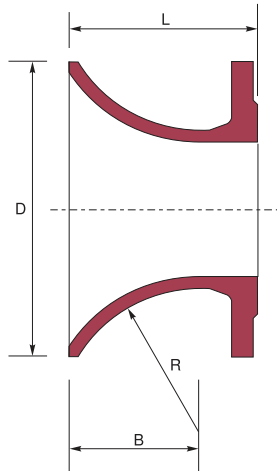

DN	L	D	B	R	Unit Wt. Kgs. PN10	Unit Wt. Kgs. PN16
80	135	160	80	100	5.2	5.2
100	140	185	85	106	6.3	6.3
150	155	245	95	119	11.0	11.0
200	170	310	110	137	24.0	24.0
250	190	370	120	150	32.0	32.0
300	210	435	135	169	44.0	44.0
350	225	495	145	181	72.0	75.0
400	245	560	160	200	92.0	98.0
450	260	620	170	212	111.0	120.0
500	280	685	185	231	138.0	153.5
600	300	810	210	262	185.3	221.0

ALL FLANGED LEVEL
INVERT TEE

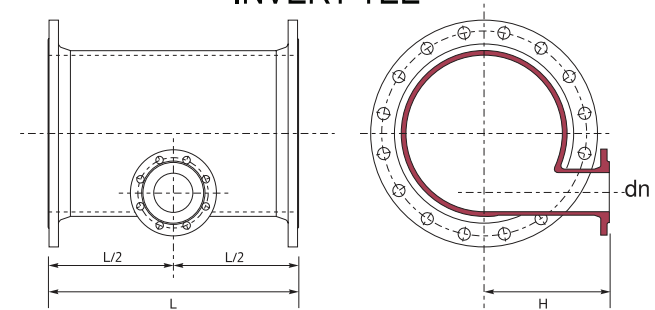

DN	dn	L	H	Unit Wt. Kgs. PN10	Unit Wt. Kgs. PN16	Unit Wt. Kgs. PN25
100	80	360	195	19.5	19.5	19.5
150	80	440	220	29.5	29.5	29.5
	100	440	220	30.5	30.5	30.5
200	80	520	250	42.5	42.5	46.5
	100	520	250	43.5	43.5	47.5
250	80	700	275	66.0	66.0	73.2
	100	700	275	68.5	68.5	75.7
300	80	800	305	92.0	92.0	102.8
	100	800	305	95.5	95.5	106.3
	150	800	305	99.0	99.0	109.8
350	80	850	340	115.6	121.0	136.8
	100	850	340	117.6	123.0	138.8
	150	850	340	122.6	128.0	143.8
400	80	900	365	144.0	153.0	175.0
	100	900	365	147.0	156.0	178.0
	150	900	365	153.0	162.0	184.0
	200	900	365	158.0	167.0	191.0
450	80	950	380	172.2	188.0	209.8
	100	950	380	173.2	189.0	210.8
	150	950	380	181.2	197.0	218.8
	200	950	380	186.2	202.0	225.8
500	80	1000	400	210.2	237.0	258.2
	100	1000	400	214.2	241.0	262.2
	150	1000	400	221.2	248.0	269.2
	200	1000	400	228.2	255.0	278.2
600	80	1100	435	302.6	350.0	373.6
	100	1100	435	303.6	351.0	374.6
	150	1100	450	312.6	360.0	383.6
	200	1100	450	322.6	370.0	395.6

EN545 FLANGED FITTINGS

DN	dn	L	Unit Wt. Kgs. PN10	Unit Wt. Kgs. PN16	Unit Wt. Kgs. PN25
100	80	200	9.5	9.5	9.8
150	80	400	16	16	17
200	100	300	15	15	17.5
200	100	600	27	27	29
250	150	300	22	22	25
250	150	600	38	38	43
300	200	300	30	29	36
300	150	600	46	46	52
350	200	600	51	51	59
350	250	300	40	41	49
350	200	600	58	60	71
400	250	600	65	70	79
400	300	300	50	52	66
400	200	600	66	71	84
450	250	600	72	77	92
450	300	600	79	84	101
450	350	300	58	67	86
450	250	600	80	88	97
500	300	600	86.8	95	107
500	350	600	92.7	104	118
500	400	300	72.4	81	113
500	250	700	99.4	114	130
500	300	600	96.2	111	129
500	400	600	110	130	153
500	450	300	116	139	157
600	300	800	145	171	191
600	400	600	132	164	190
600	450	600	140	175	195
600	500	600	149	190	216

DOUBLE FLANGED CONCENTRIC TAPER

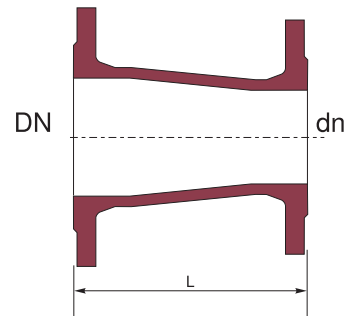

DOUBLE FLANGED FLAT TAPER

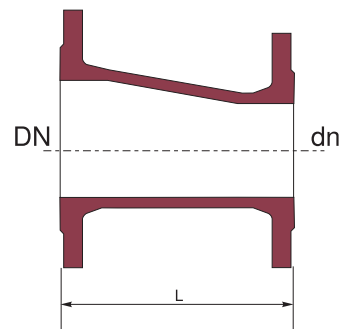

BLANK FLANGE

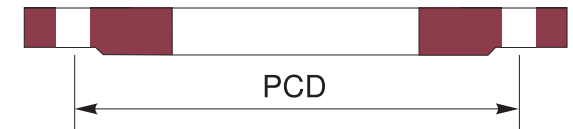

DN	Unit Wt. Kgs. PN10	Unit Wt. Kgs. PN16	Unit Wt. Kgs. PN25
80	3.9	3.9	3.9
100	4.8	4.8	4.8
150	8.1	8.1	8.1
200	11.4	11.4	13.4
250	16.6	16.6	20.2
300	23.0	23.0	28.4
350	34.3	37.0	44.9
400	44.0	48.5	59.5
450	55.6	63.5	74.4
500	69.6	83.0	93.6
600	106.3	130.0	141.8

FLANGED (FABRICATED) DUCTILE PIPE EN545

FLANGE X PLAIN END PIPE

Nominal Diameter DN	L *	Weight with flange		
		PN 10 Kg	PN 16 Kg	PN 25 Kg
80	350	7.9	8.0	8.0
100	350	9.6	9.6	10.1
150	400	17.1	17.1	18.1
200	400	24.5	24.0	25.5
250	400	33.0	33.0	35.5
300	450	46.0	45.0	49.0
350	450	58.0	58.0	64.0
400	480	70.0	74.0	83.0
500	520	104.0	117.0	123.0
600	560	144.0	169.0	172.0

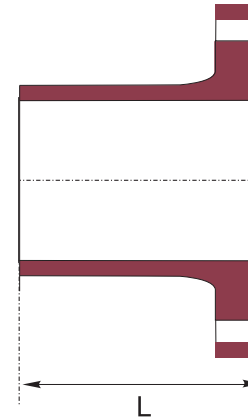

FLANGE X FLANGE PIPE

Nominal Diameter DN	Weight with Flange			Weight with Flange		
	Effective length = 250mm *			Effective length = 500mm *		
	PN 10 kg	PN 16 kg	PN 25 kg	PN 10 kg	PN 16 kg	PN 25 kg
80	9.6	9.6	9.8	12.9	12.9	13.3
100	11.5	11.5	12.5	13.4	13.4	16.9
150	19.0	19.0	21.0	26.0	26.0	28.0
200	26.5	26.0	29.0	36.5	36.0	39.5
250	40.5	39.5	45.5	57.0	56.0	62.0
300	53.0	52.0	59.0	75.0	73.0	80.0
350	69.0	71.0	83.0	99.0	100.0	112.0
400	80.0	88.0	106.0	113.0	123.0	141.0
500	95.0	122.0	157.0	104.0	117.0	138.0
600	129.0	178.0	201.0	139.0	166.0	215.0

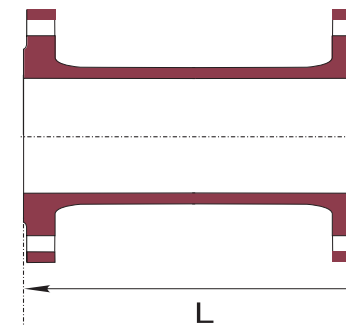

* length can be supplied from the range of 0.3m to 1.0m

EN545 SOCKET & MECHANICAL JOINT FITTINGS

DN	B	Unit Wt. Kgs.	
		T-Type	K-Type
80	100	8.6	
100	120	11.4	
150	170	20.5	
200	220	33	
250	270	48.5	
300	320	68	
350	370	98.4	
400	420	129	
450	470	163	
500	520	204	
600	620	303	

DOUBLE
SOCKET
90° BEND

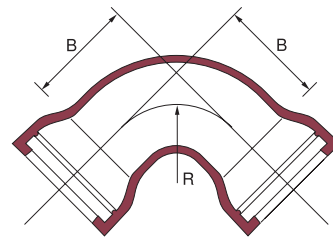

DN	B	Unit Wt. Kgs.	
		T-Type	K-Type
80	40	7.5	--
100	40	9.5	
150	55	16.0	
200	65	24.0	
250	75	33.5	
300	85	44.5	
350	95	58.0	
400	110	74.0	
450	120	102.0	
500	130	111.0	
600	150	157.0	

DOUBLE
SOCKET
22.5° BEND

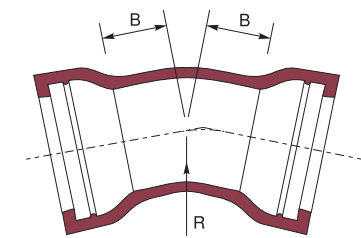

DN	B	Unit Wt. Kgs.	
		T-Type	K-Type
80	55	8.0	
100	65	10.0	
150	85	17.5	
200	110	27.0	
250	130	38.5	
300	150	53.0	
350	175	70.0	
400	195	89.0	
450	220	123.0	
500	240	129.0	
600	285	202.0	

DOUBLE
SOCKET
45° BEND

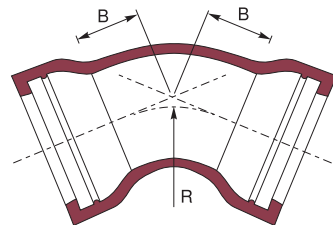

DN	B	Unit Wt. Kgs.	
		T-Type	K-Type
80	30	7.0	
100	30	9.0	
150	35	15.0	
200	40	22.0	
250	50	30.5	
300	55	40.5	
350	60	52.0	
400	65	65.0	
450	70	91.9	
500	75	96.0	
600	85	134.0	

DOUBLE
SOCKET
11.5° BEND

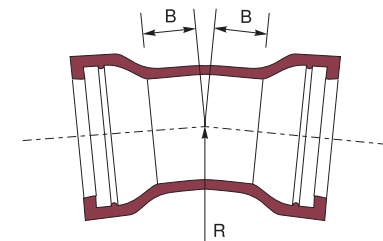

EN545 SOCKET & MECHANICAL JOINT FITTINGS

DOUBLE SOCKET
90° DUCK-FOOT BEND

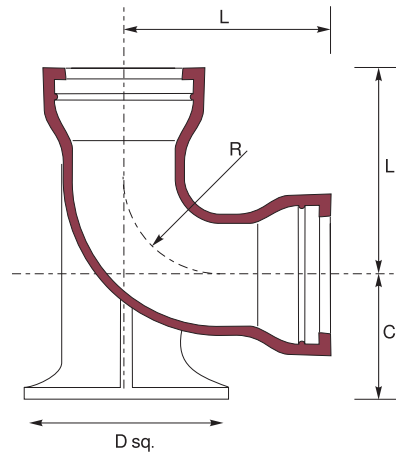

DN	L	C	D	R	Unit Wt. Kgs. T-Type
80	100	110	180	80.0	11.3
100	120	125	200	95.0	14.8
150	170	160	250	145.0	28.5
200	220	190	300	195.0	44.5
250	270	225	350	245.0	68.5
300	320	255	400	290.0	100.0
350	370	290	450	340.0	133.0
400	420	320	500	390.0	180.0
450	470	355	550	435.0	230.0
500	520	385	600	485.0	294.0
600	620	450	700	580.0	442.0

ALL SOCKET EQUAL CROSS

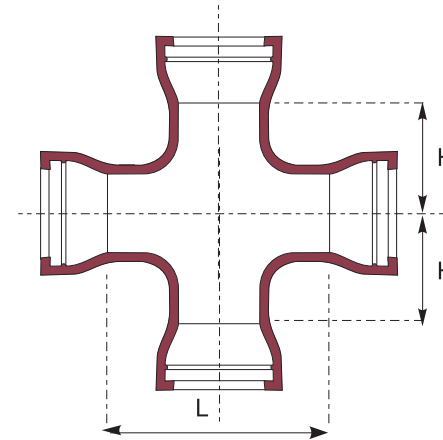

DN	L	H	Unit Wt. Kgs.	
			T-Type	K-Type
80	165	85	15.0	
100	190	95	20.0	
150	255	125	33.5	
200	315	155	51.0	
250	375	185	75.0	
300	435	220	101.0	
350	495	250	137.0	
400	560	280	177.0	
500	680	340	272.0	
600	800	400	399.0	

EN545 SOCKET & MECHANICAL JOINT FITTINGS

DN	dn	L	H	Unit Wt. Kgs. T-Type
80	80	170	85	12.5
100	80	170	95	15
	100	190	95	16
150	80	170	120	21.5
	100	195	120	23.5
	150	255	125	28
200	80	175	145	30
	100	200	145	32
	150	255	150	37
	200	315	155	43
250	80	175	165	40
	100	200	165	43
	150	260	175	51
	200	315	180	56
	250	375	185	53
300	80	180	190	51
	100	200	195	54
	150	260	200	64
	200	320	205	70
	250	375	210	80
	300	435	215	56
350	80	180	215	64
	100	205	220	67
	150	265	225	80
	200	320	230	85
	250	380	235	97
	300	435	240	106
	350	495	245	116
400	100	210	245	82
	150	265	240	97

DN	dn	L	H	Unit Wt. Kgs. T-Type
	200	325	255	102
	250	380	260	116
	300	440	265	127
	350	500	270	137
	400	555	275	150
450	100	210	270	106
	150	270	275	116
	200	325	280	127
	250	385	285	138
	300	445	290	149
	350	500	295	161
	400	500	300	173
	450	615	305	186
500	150	270	300	137
	200	330	305	141
	250	390	315	161
	300	445	315	174
	350	505	320	187
	400	560	325	199
	450	620	330	214
	500	680	340	234
600	150	280	350	185
	200	335	355	188
	250	395	360	215
	300	450	365	231
	400	570	375	258
	450	625	380	280
	500	685	390	296
	600	800	400	343

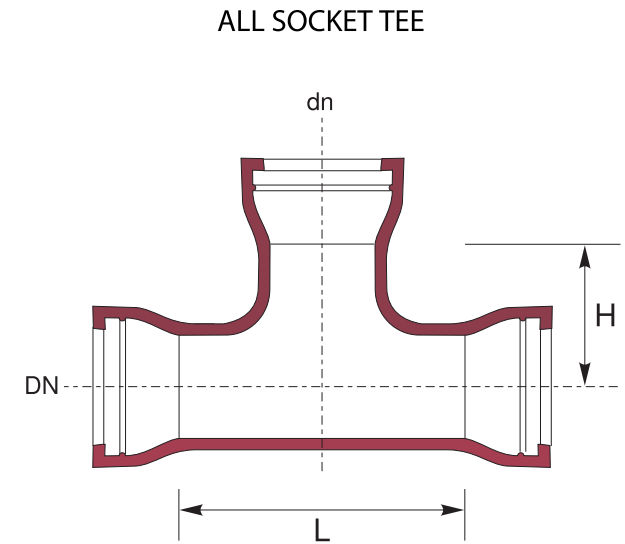

All dimensions are in mm

EN545 SOCKET & MECHANICAL JOINT FITTINGS

DN	dn	L	H	Unit Wt. Kgs. T-Type
80	80	170	160	13.5
100	80	170	175	16
	100	190	180	17
150	80	170	205	23
	100	195	210	24.5
	150	255	220	29.5
200	80	175	235	31.5
	100	200	240	34
	150	255	250	39
	200	315	260	46
250	80	175	265	44
	100	200	270	43.5
	150	260	280	56.5
	200	315	290	57
	250	375	300	66
300	100	200	300	55
	150	260	310	68
	200	320	320	70
	250	375	330	81
	300	435	340	91
350	100	205	330	68
	150	265	340	81.3
	200	320	350	86
	250	380	360	114
	300	435	370	118

DN	dn	L	H	Unit Wt. Kgs. T-Type
	350	495	380	120
400	100	210	360	83
	150	265	370	98
	200	325	380	102
	250	380	390	118
	300	440	400	131
	350	500	410	146
	400	560	420	156
450	100	210	390	107
	150	270	400	119
	200	325	410	129
	250	385	420	140
	300	445	430	154
	350	500	440	169
	400	560	450	185
	450	615	460	200
500	100	215	420	116
	150	270	430	137
	200	330	440	141
	250	390	450	165
	300	445	460	179
	350	505	470	195
	400	565	480	205
	450	620	490	228
	500	680	500	247
600	100	220	480	171
	150	280	490	187
	200	340	500	189
	250	395	510	218
	300	450	520	235
	400	570	540	263
	450	625	550	293
	500	685	560	309
	600	800	580	366

Weight with PN 16 Flange indicated

DOUBLE SOCKET
TEE WITH PN16 FLANGE
BRANCH

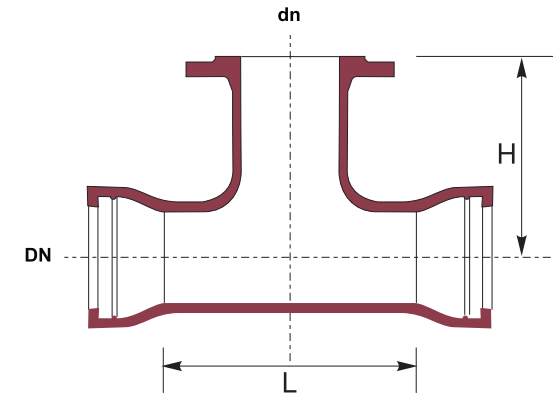

All dimensions are in mm

EN545 SOCKET & MECHANICAL JOINT FITTINGS

ALL SOCKET
45° ANGLE BRANCH

DN	L	H	Unit Wt. Kgs. T Type
80	500	375	19.0
100	540	405	26.0
150	640	480	46.0
200	735	560	72.0
250	830	640	106.0
300	930	715	151.0
350	880	790	169.0
400	970	870	209.0
450	1060	950	281.0
500	1140	1025	347.0
600	1310	1180	511.0

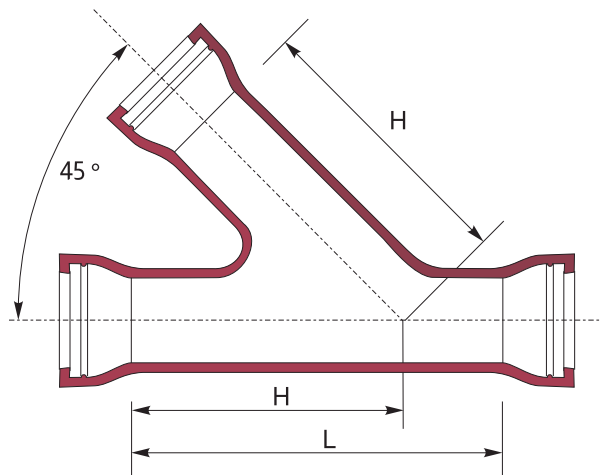

ALL SOCKET
RADIAL TEE

DN	A	B	L	R	Unit Wt. Kgs. T Type
80	165	380	545	330	21.0
100	180	400	580	340	28.0
150	220	450	670	385	47.0
200	260	500	760	430	72.5
250	350	550	900	475	107.0
300	400	600	1000	515	150.0
350	450	650	1100	560	206.0

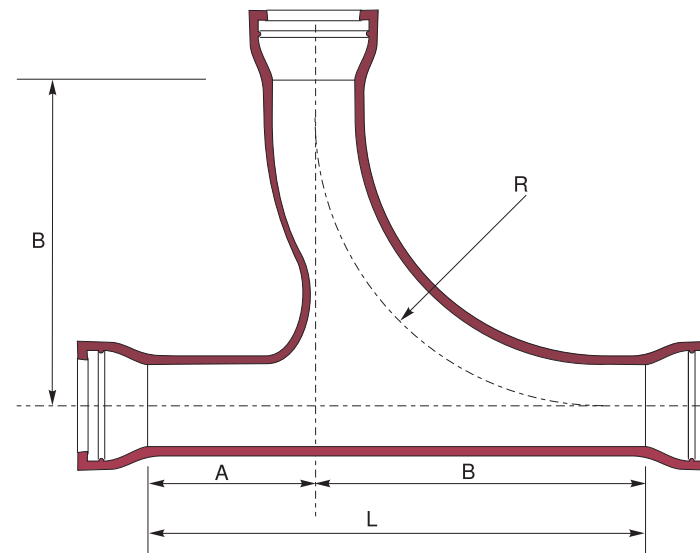

All dimensions are in mm

EN545 SOCKET & MECHANICAL JOINT FITTINGS

DOUBLE SOCKET TEE WITH FLANGED LEVEL INVERT

DN	Branch	L	H	Unit Wt. Kgs. T-Type
200	100	200	240	36.5
	150	250	250	44
250	100	200	270	47.5
	150	255	280	62
	200	315	290	65
300	100	205	300	59
	150	260	310	74
	200	320	320	79
350	100	205	330	73
	150	265	340	92
	200	325	350	96
400	100	210	360	89
	150	265	370	101
	200	325	380	114
	250	380	390	133
450	100	210	400	114
	150	270	400	130
	200	325	410	142
	250	385	420	154
	300	445	430	174
500	100	215	420	124
	150	274	430	150
	200	330	440	157
	250	390	450	181
	300	445	460	201
600	100	220	480	185
	150	280	490	199
	200	340	500	205
	250	395	510	238
	300	450	520	257
	350	510	530	289
	400	570	540	300

Weight with PN 16 Flange indicated

All dimensions are in mm

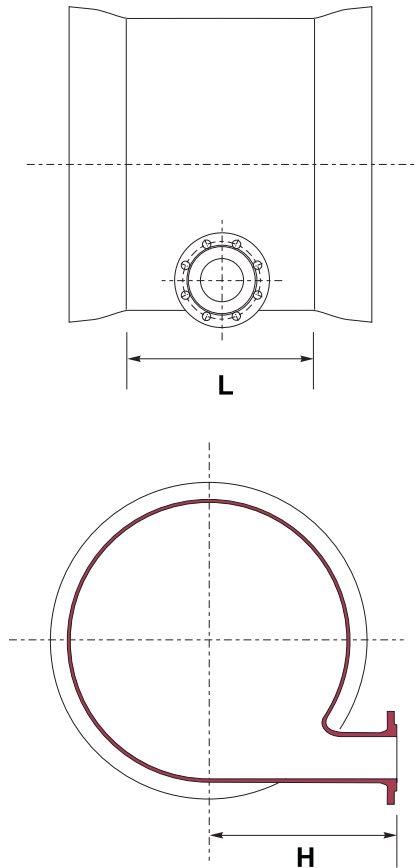

DOUBLE SOCKET CONCENTRIC TAPER

DN	dn	L	Unit Wt. Kgs. T-Type
100	80	90	8.5
150	80	190	13.5
	100	150	13.8
200	100	250	20.5
	150	150	21
250	100	300	28.5
	150	250	29
	200	150	29
300	100	450	39
	150	350	39.5
	200	250	39.5
	250	150	38.5
350	150	460	52
	200	360	51
	250	260	50
	300	160	50
400	200	460	67
	250	360	66
	300	260	64
	350	160	62
450	200	560	89
	250	460	89
	300	360	88
	350	260	86
	400	160	83
500	250	560	101
	300	460	100
	350	360	98
	400	260	94
	450	160	99
600	300	660	152
	350	560	151
	400	460	142
	450	360	149
	500	260	131

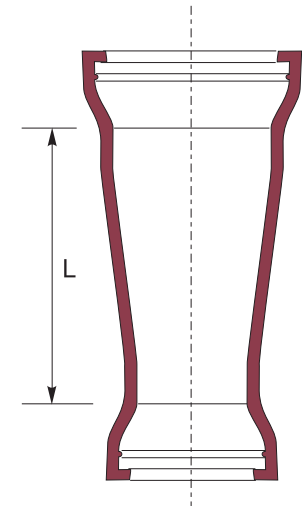

EN545 SOCKET & MECHANICAL JOINT FITTINGS

FLANGE X SOCKET PIECE

DN	L	Unit Wt. Kgs.
80	130	7.4
100	130	9.0
150	135	14.2
200	140	20.0
250	145	27.5
300	150	36.0
350	155	48.5
400	160	60.0
450	165	78.5
500	170	93.0
600	180	135.0

With PN 16 Flanges

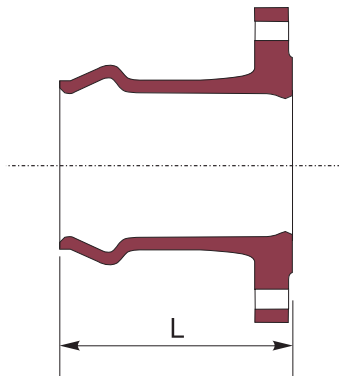

FLANGE X SPIGOT PIECE

DN	L	Unit Wt. Kgs.
80	350	7.8
100	360	9.7
150	380	15.8
200	400	23.0
250	420	32.0
300	440	42.5
350	460	55.5
400	480	70.0
450	500	88.0
500	520	109.0
600	560	159.0
700	600	194.0
800	600	254.0
900	600	295.0
1000	600	369.0
1200	600	520.0
1400	710	734.0
1600	780	1024.0
1800	850	1322.0
2000	920	1687.0
2200	990	2115.0

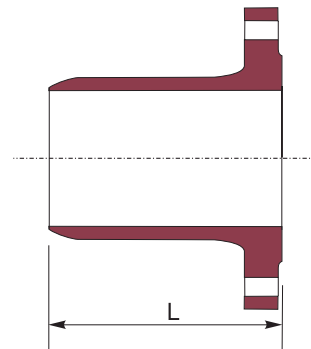

COLLAR SOCKET

DN	d	L	Unit Wt. Kgs. T Type
80	109	160	7.9
100	130	160	9.9
150	183	165	15.9
200	235	170	23.0
250	288	175	31.5
300	340	180	41.0
350	393	185	52.0
400	445	190	64.0
450	498	195	91.0
500	550	200	93.0
600	655	210	129.0

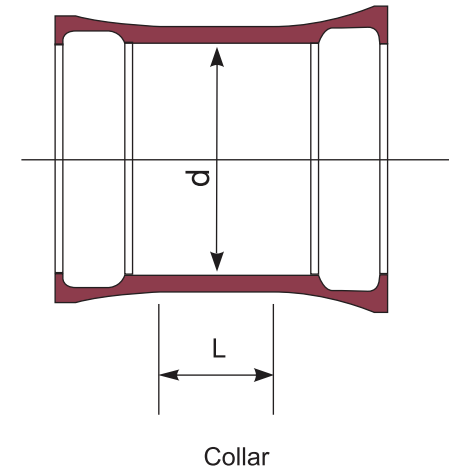

All dimensions are in mm

EN545 SOCKET & MECHANICAL JOINT FITTINGS

DOUBLE SOCKET CONCENTRIC TAPER

DN	dn	L	Unit Wt. Kgs. T-Type
100	80	90	8.5
150	80	190	13.5
	100	150	13.8
200	100	250	20.5
	150	150	21
250	100	300	28.5
	150	250	29
	200	150	29
300	100	450	39
	150	350	39.5
	200	250	39.5
	250	150	38.5
350	150	460	52
	200	360	51
	250	260	50
	300	160	50
400	200	460	67
	250	360	66
	300	260	64
	350	160	62

DN	dn	L	Unit Wt. Kgs T-Type
450	200	560	89
	250	460	89
	300	360	88
	350	260	86
	400	160	83
500	250	560	101
	300	460	100
	350	360	98
	400	260	94
	450	160	99
600	300	660	152
	350	560	151
	400	460	142
	450	360	149
	500	260	131

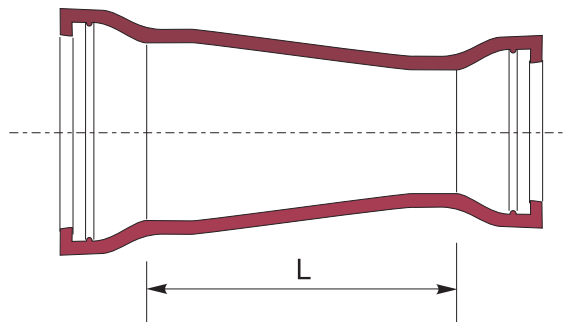

FLANG SOCKET PIECES

Nominal diameter DN	L mm	L ₁ mm	Mass with flang		
			PN 10 kg	PN 16 kg	PN 25 kg
80	110	195.0	7.5	7.5	7.6
100	110	198.0	9.1	9.1	9.6
150	115	209.0	15.0	15.0	16.0
200	120	220.0	21.0	21.0	23.0
250	125	230.0	35.5	35.0	38.0
300	130	240.0	44.5	44.5	48.0
350	135	245.0	59.0	59.0	66.0
400	140	250.0	65.0	69.0	78.0
500	170	290.0	85.0	98.0	104.0
600	180	300.0	124.0	149.0	152.0

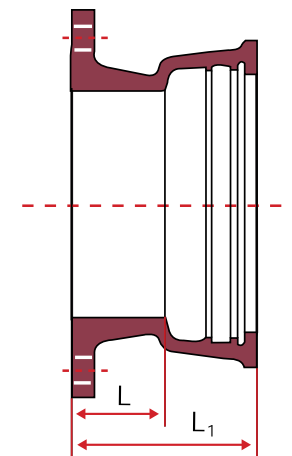

PRODUCT CATEGORIES

- Double Socket Bends
- All Sockets Tee
- Double Flanged Bend
- Double Socket Taper
- All Socket Radial Tee
- Flange Socket
- Collar Socket & Glands

MARKINGS

All fittings will be durably and legible marked the following indications

- Manufacturer's name or trademark
- The identification of the year of manufacturing
- Identification mark for ductile
- The PN rating of fittings where applicable
- The reference of international standard



GENERAL SPECIFICATIONS FOR ISO / EN PIPE FITTINGS DUCTILE IRON:

FOR PORTABLE WATER

ISO 2531: Ductile iron pipes, fittings, accessories and their joints for water applications

EN 545: Ductile iron pipes, fittings, accessories and their joints for water pipelines

ISO 4179: Ductile iron pipes for pressure and non-pressure pipelines - cement mortar lining

ISO 7005-2: Metallic flanges - Part 2: Cast iron flanges

EN 1092-2: Flanges and their joints, Circular flanges for pipes, valves, fittings and accessories

ISO 8179-2: Ductile iron pipes - External zinc-based coating

EN 14901: Epoxy coating (heavy duty) of ductile iron fittings and accessories

EN 15655: Internal polyurethane lining for pipes and fittings

ISO 4633: Joint rings for water supply, draining and sewerage pipelines

ISO 8180: Ductile iron pipes - Polyethylene sleeving

FOR SEWORAGE APPLICATION

EN598: Ductile iron pipes, fittings, accessories and their joints for sewerage applications

ISO 7186 Ductile iron product for Sewerage Application

ISO 4633: Joint rings for water supply, drainage and sewerage pipelines

LINING AND COATING FOR DUCTILE IRON FITTINGS:

External Coating Options	Internal Coating Options:
Zinc + Bitumen painting	Cement mortar lining
liquid epoxy resin painting	liquid epoxy resin painting
Fusion Bonded Epoxy lining (FBE)	Fusion Bonded Epoxy lining (FBE)
	Polyethylene sleeving (applied on site)
According to customers' requirements	According to customers' requirements
Thickness according to standard and customers' requirements.	







PRODUCT CLASS(LOAD):

MANHOLE COVERS AND GULLY TOPS: EN 124-1/2

SURFACE BOX/VALVE BOXES: BS 5834, PART 2/3, GRADE A,B,C

CHANNEL GRATES: EN 1433



CLASS	LOAD BEARING REQUIRED	APPLICATION IN APPROPRIATES AREAS
A 15	15 KN (3400 lbf)	FOR USE IN PEDESTRIAN AREA 
B 125	125 KN (28200 lbf)	FOR USE IN FOOTWAYS, PEDSTRIAN AREAS AND CAR PARKS 
C 250	250 KN (56300 lbf)	FOR USE IN KERBSIDE CHANNELS OF ROADS AND CAR PARKS. 
D 400	400 KN (90000 lbf)	FOR USE IN CARRIAGEWAYS, HARD SHOULDERS AND PARKING AREAS. 
E 600	600 KN (134900 lbf)	FOR USE IN HIGH WHEEL LOADS AREAS LIKE DOCKS AND AIRCRAFT PAVEMENT. 
F 900	900 KN (202400 lbf)	FOR USE IN VERY HIGH WHEEL LOADS AREAS AIRCRAFT PAVEMENTS. 

PRODUCT AT A GLANCE

SURFACE PREPARATION AND PROTECTIVE COATING:

Manhole covers and gully tops are blast cleaned(EN ISO 8503) and coated with epoxy primer and black solvent free epoxy paint finish with minimum DFT of $300\mu\text{m}$ / $200\mu\text{m}$ (based on the purpose of use).

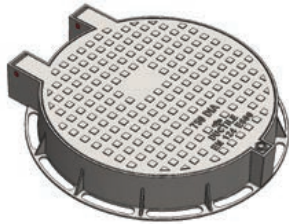

CIRCULAR COVERS AND FRAMES

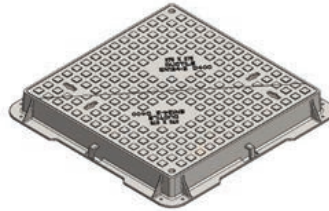

SQUARE/RECTANGULAR COVERS

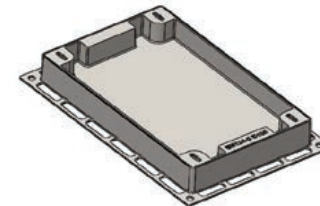

RECESSED COVERS AND FRAMES

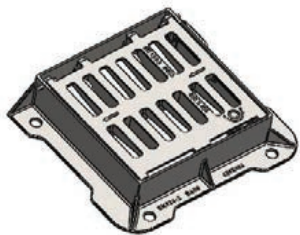

GULLY GRATES AND FRAMES

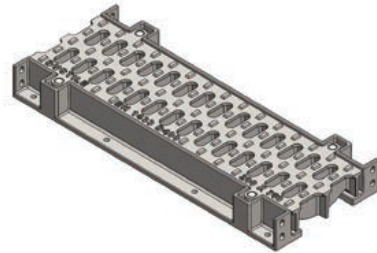

CHANNEL GRATINGSSUR

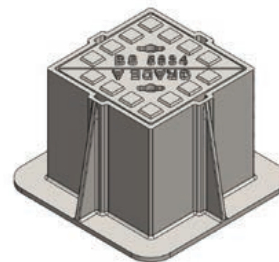

FACE/VALVE BOXES



TREE GRATINGS

CIRCULAR COVERS AND FRAMES

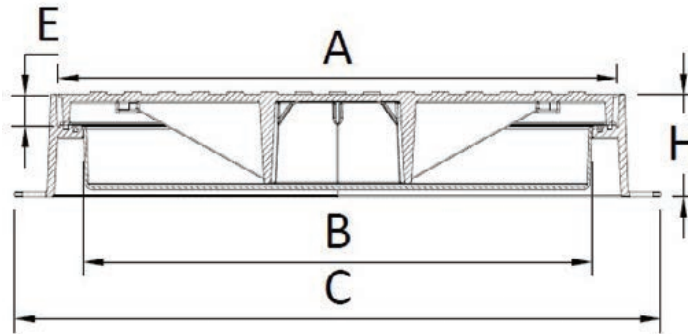
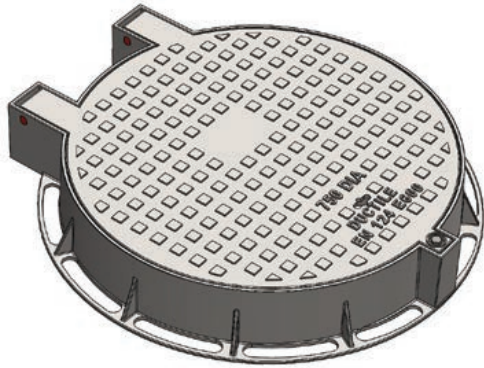

Features

- Hinged cover
- Cover locked with frame (SS Bolt)
- Cushion insert (Rubber gasket)

Options

- GRP seal plate provision
- Grease seal

Product code	B Ø (mm)	A Ø (mm)	C Ø (mm)	E (mm)	H (mm)	Load class	Material Product code
MC-750-E600-AS-04-001	750	823	950	45	150	EN 124: E600	DUCTILE IRON
MC-750-D400-AS-04-002	750	823	950	35	100	EN 124: E400	DUCTILE IRON

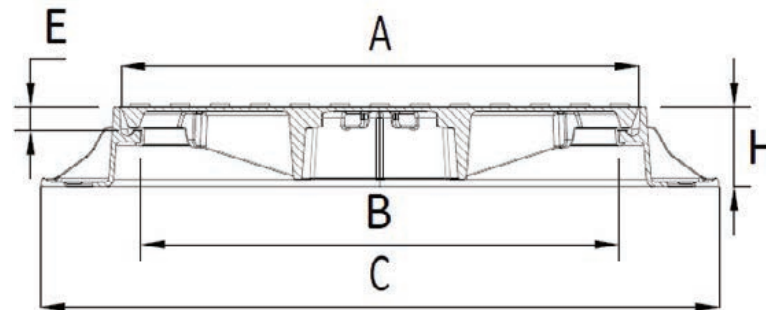
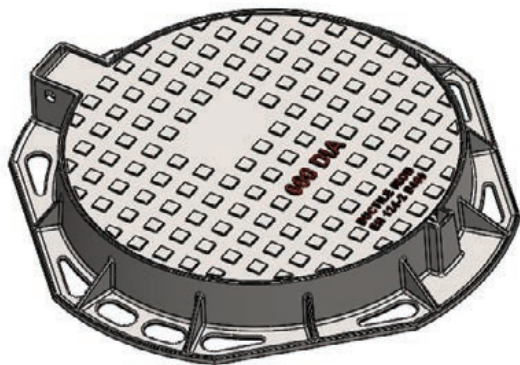

Features

- Hinged cover
- Cover locked with frame
- Cushion insert (Rubber gasket)

Options

- GRP seal plate provision
- Grease seal

Product code	B Ø (mm)	A Ø (mm)	C Ø (mm)	E (mm)	H (mm)	Load class	Material Product code
MC-600-D400-AS-04-001	600	650	850	30	100	EN 124: D400	DUCTILE IRON
MC-600-E600-AS-04-002	600	650	850	40	150	EN 124: E600	DUCTILE IRON

CIRCULAR COVERS AND FRAMES

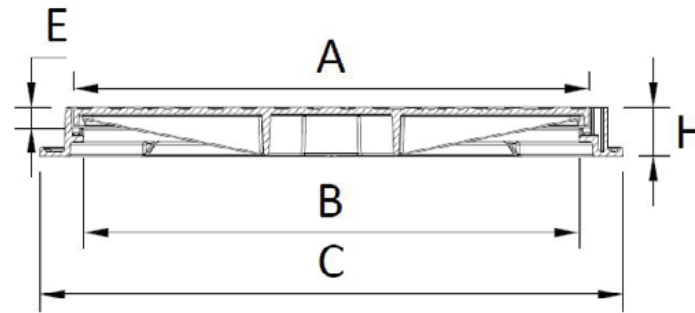
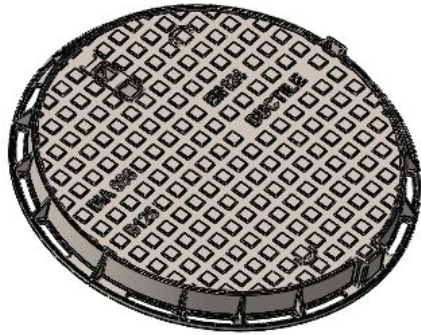

Features

- Hinged cover
- Cover locked with frame
- Cushion insert (SEAL)

Options

- Additional self-lock.

Product code	B Ø (mm)	A Ø (mm)	C Ø (mm)	E (mm)	H (mm)	Load class	Material Product code
MC-600-B125-AS-04-003	600	627	708	26	60	EN 124: B125	DUCTILE IRON
MC-600-D400-AS-04-004	600	635	705	50	100	EN 124: D400	DUCTILE IRON

RECESSED COVERS AND FRAMES

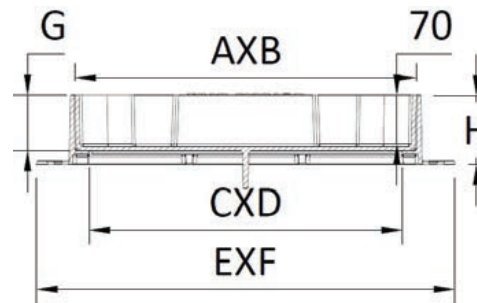
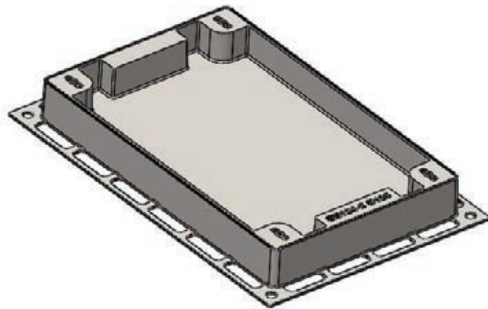

Features

- Recessed cover and frame with infilling area
- Key holes for handling
- Infilling depth-70mm)

Options

- With cover locking system.

Product code	CXD (mm)	AXB (mm)	EXF (mm)	G (mm)	H (mm)	Load class	Material Product code
RC-450X750-B125-AS-04 - 001	450X750	490x790	850	30	100	EN 124: D400	DUCTILE IRON
RC-600x600-D400-AS-04 - 001	600x600	650x650	850	40	150	EN 124: E600	DUCTILE IRON

SQUARE/RECTANGULAR COVERS AND FRAMES

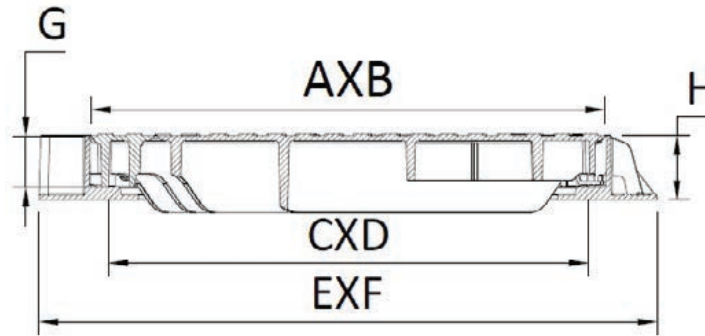
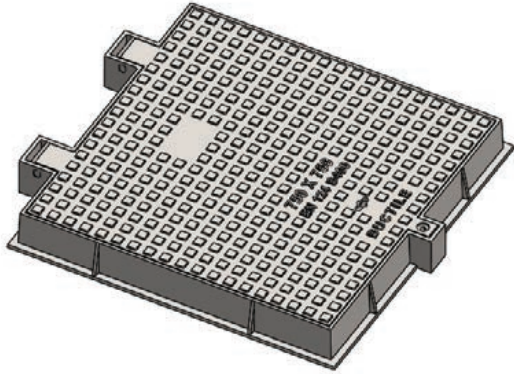

Features

- Hinged cover
- Cover locked with frame (SS Bolt)
- Cushion insert (Rubber gasket)

Options

- GRP seal plate provision

Product code	CXD (mm)	AXB (mm)	EXF (mm)	G (mm)	H (mm)	Load class	Material Product code
MC-750X750-D400-AS-04 - 001	750X750	815X815	950X950	35	100	EN 124: D400	DUCTILE IRON
MC-750X750-E600-AS-04-002	750X750	815X815	950X950	45	150	EN 124: E600	DUCTILE IRON

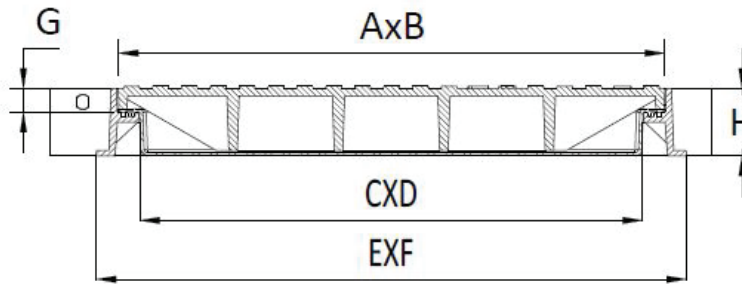
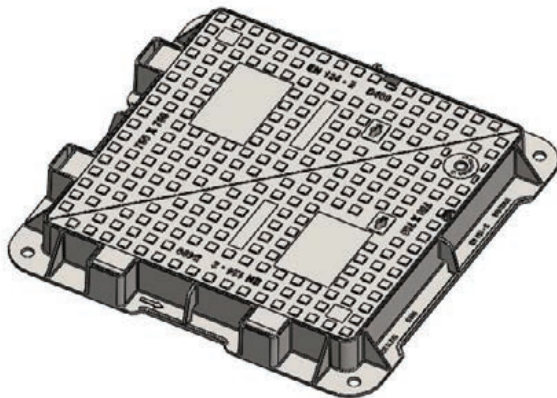

Features

- Hinged covers.
- Double triangular covers
- Cover locked with frame.

Options

- GRP seal plate provision

Product code	CXD (mm)	AXB (mm)	EXF (mm)	G (mm)	H (mm)	Load class	Material Product code
MC-750X750 DT-D400-AS-04 - 001	750X750	805X805	970X970	80	100	EN 124: D400	DUCTILE IRON
MC-750X750 DT-E600-AS-04-002	750X750	805X805	970X970	120	150	EN 124: E600	DUCTILE IRON

SQUARE/RECTANGULAR COVERS AND FRAMES

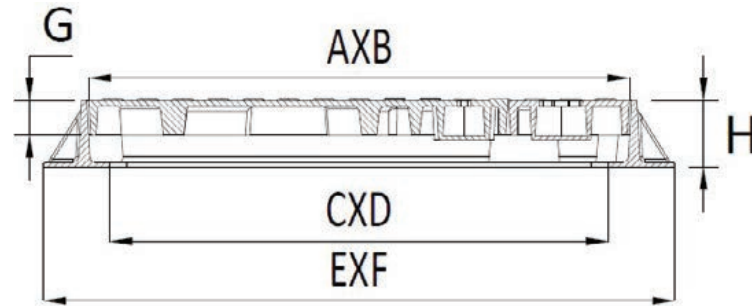
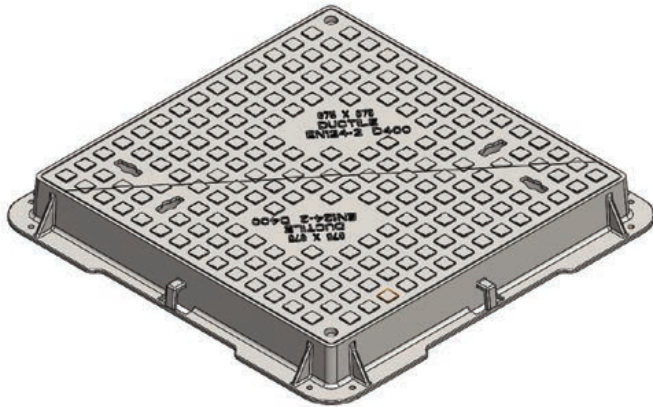

Features

- Double Triangular covers
- Covers connected with SS bolts
- Cover locked with frame

Options

- GRP seal plate provision

Product code	CXD (mm)	AXB (mm)	EXF (mm)	G (mm)	H (mm)	Load class	Material Product code
MC-675X675 DT-D400-AS-04 - 001	675X675	730X730	855X855	60	100	EN 124: D400	DUCTILE IRON
MC-750X750 DT-D400-AS-04-003	750X750	810X810	950X950	75	100	EN 124: D400	DUCTILE IRON
MC-600X600 DT-D400-AS-04-001	600X600	640X640	760X760	60	100	EN 124: D400	DUCTILE IRON

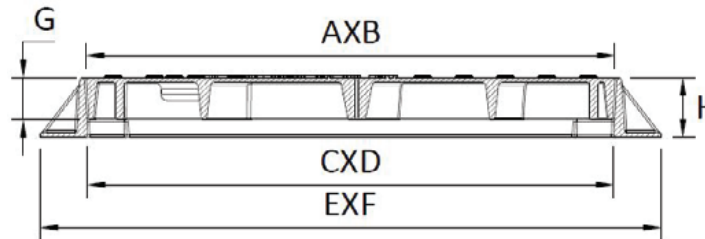
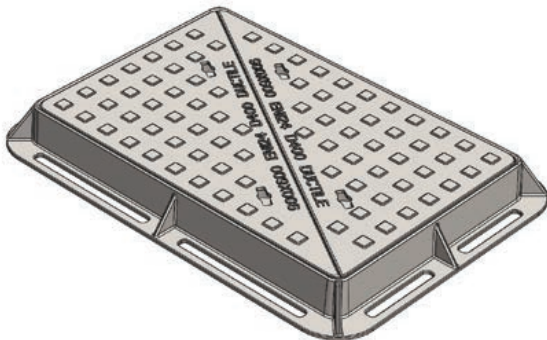

Features

- Double Triangular covers
- Covers connected with SS bolts

Options

- Cover locked with frame.

Product code	CXD (mm)	AXB (mm)	EXF (mm)	G (mm)	H (mm)	Load class	Material Product code
MC-900X600 DT-D400-AS-04 - 001	900X600	895X595	1050X750	70	100	EN 124: D400	DUCTILE IRON
MC-900X600 DT-E600-AS-04-002	900X600	895X595	1080X800	100	150	EN 124: E600	DUCTILE IRON

SQUARE/RECTANGULAR COVERS AND FRAMES

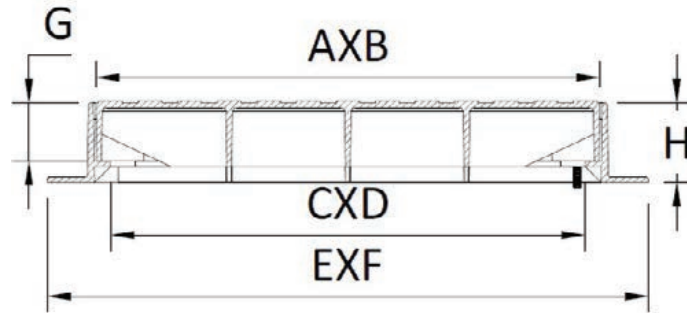
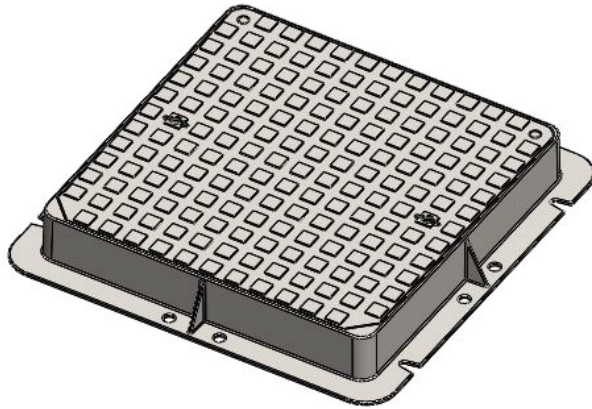

Features

- Cover locked with frame
- Slide out cover

Options

- Cushion inserts

Product code	CXD (mm)	AXB (mm)	EXF (mm)	G (mm)	H (mm)	Load class	Material Product code
MC-600X600-B125-AS-04 - 001	600X600	635X635	750X750	40	60	EN 124: B125	DUCTILE IRON
MC-600X600-D400-AS-04 - 002	600X600	635X635	760X760	75	100	EN 124: D400	DUCTILE IRON
MC-600X600-E600-AS-04 - 003	600X600	640X640	780X780	100	150	EN 124: E600	DUCTILE IRON
MC-600X600-F900-AS-04 - 004	600X600	640X640	780X780	100	150	EN 124: F900	DUCTILE IRON
MC-800X800-D400-AS-04 - 001	800X800	840X840	980X980	80	100	EN 124: D400	DUCTILE IRON
MC-800X800-F900-AS-04 - 002	800X800	840X840	980X980	110	150	EN 124: F900	DUCTILE IRON
MC-900X900-D400-AS-04 - 001	900X900	950X950	1080X1080	80	100	EN 124: D400	DUCTILE IRON
MC-900X900-F900-AS-04 - 002	900X900	950X950	1080X1080	110	150	EN 124: F900	DUCTILE IRON

GULLY GRATES AND FRAMES

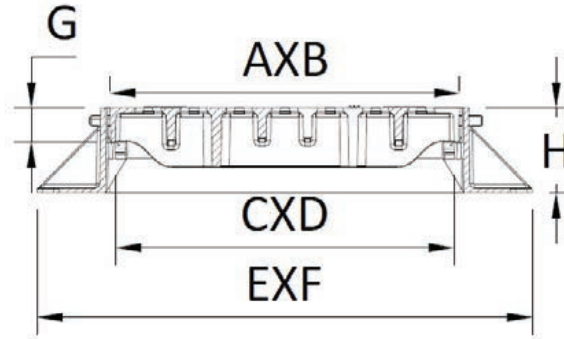
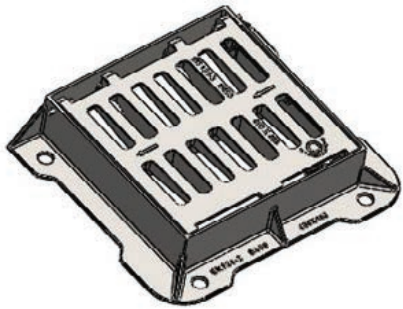

Features

- Hinged Gate

Options

- Lockable
- Four Flanged

Product code	CXD (mm)	AXB (mm)	EXF (mm)	G (mm)	H (mm)	Load class	Material Product code
GG-400X400-D400-AS-04 - 001	400X400	404X413	585X500	50	100	EN 124: D400	DUCTILE IRON
GG-435X435-C250-AS-04 - 001	435X435	475X475	590X540	50	75	EN 124: C250	DUCTILE IRON
GG-450X450-D400-AS-04 - 001	450X450	490X490	600X600	60	100	EN 124: D400	DUCTILE IRON

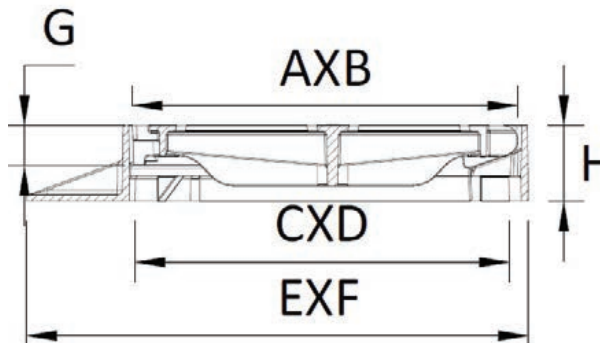
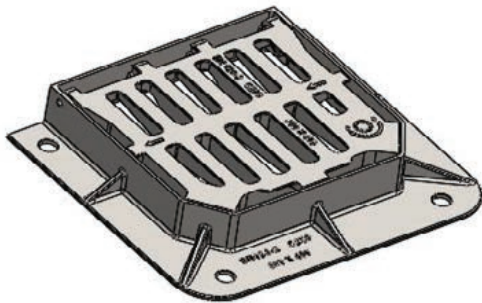

Features

- Hinged Gate

Options

- Lockable
- Four Flanged

Product code	CXD (mm)	AXB (mm)	EXF (mm)	G (mm)	H (mm)	Load class	Material Product code
GG-380X400-C250-AS-04 - 001	380X400	385X416	580X500	40	75	EN 124: C250	DUCTILE IRON
GG-380X400-C250-AS-04 - 002	380X400	385X416	580X580	40	75	EN 124: C250	DUCTILE IRON
GG-380X400-D400-AS-04 - 003	380X400	385X416	580X580	50	100	EN 124: D400	DUCTILE IRON

GULLY GRATES AND FRAMES

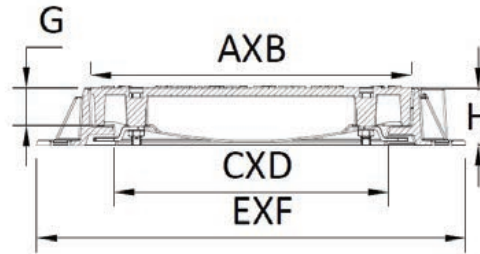
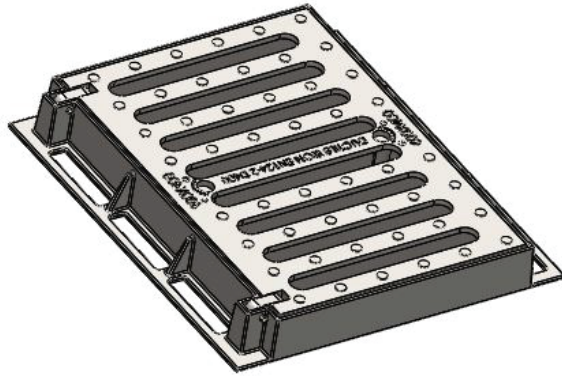

Features

- Hinged Grate

Options

- Grate locked with frame

Product code	CXD (mm)	AXB (mm)	EXF (mm)	G (mm)	H (mm)	Load class	Material Product code
GG-600X400-D400-AS-04 - 001	600X400	675X475	705X635	78	85	EN 124: D400	DUCTILE IRON
GG-600X600-D400-AS-04 - 001	600X600	580X580	800X800	60	100	EN 124: D400	DUCTILE IRON

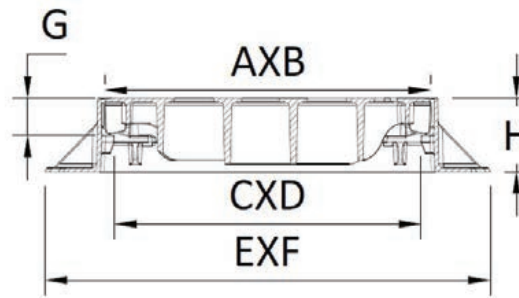
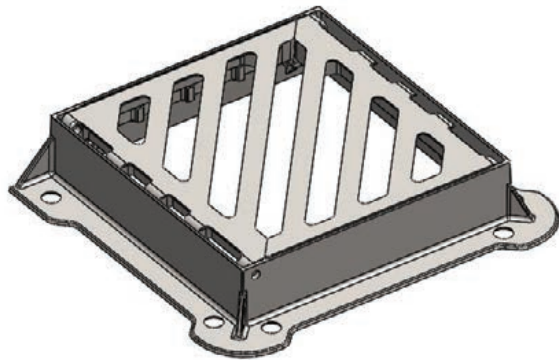

Features

- Double Triangular Hinged Grate and frame
- Grates are connected with SS bolts.

Options

- Four Flanged

Product code	CXD (mm)	AXB (mm)	EXF (mm)	G (mm)	H (mm)	Load class	Material Product code
GG-415X430 DT-D400-AS-04 - 002	415X430	445X445	535X605	50	100	EN 124: D400	DUCTILE IRON
GG-600X600 DT-D400-AS-04 - 002	600X600	640X640	780X780	60	100	EN 124: D400	DUCTILE IRON

CHANNEL GRATES

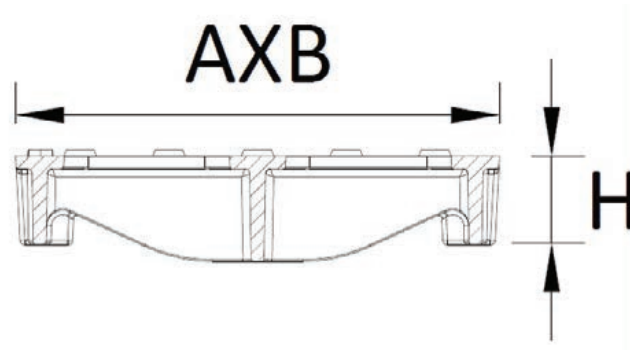
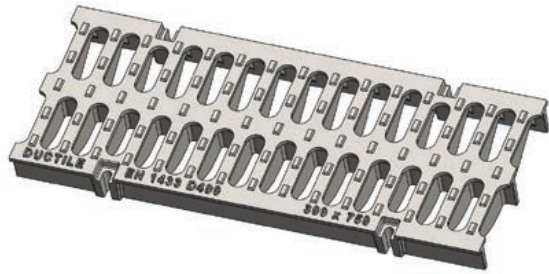

Features

- Lockable Channel grate

Options

- With side Frames

Product code	AXB (mm)	H (mm)	Load class	Material Product code
CG-300X750G-D400-CA-04 - 001	300X750	55	EN 1433: D400	DUCTILE IRON
CG-225X750G-D400-CA-04 - 001	225X750	45	EN 1433: D400	DUCTILE IRON
CG-150X750G-D400-CA-04 - 001	150X750	35	EN 1433: D400	DUCTILE IRON

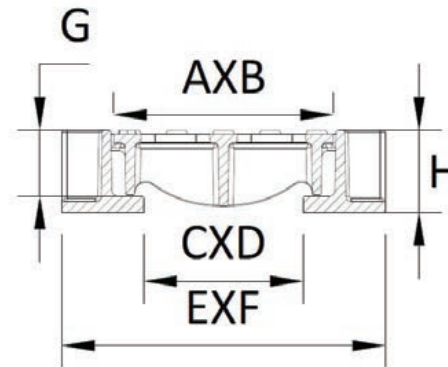
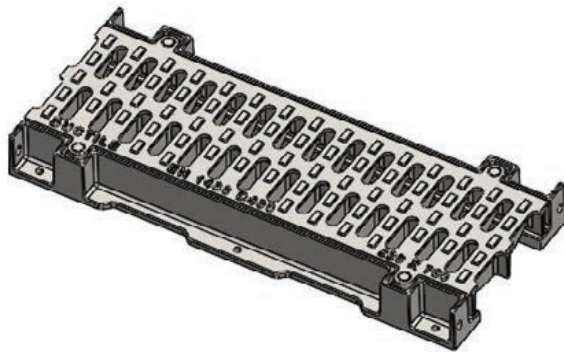

Features

- Lockable Channel grate

Options

- With side Frames

Product code	CXD (mm)	AXB (mm)	EXF (mm)	G (mm)	H (mm)	Load class	Material Product code
CG-225X750-D400-AS-04 - 001	175X750	225X750	315X750	55	75	EN 1433: D400	DUCTILE IRON
CG-300X750-D400-AS-04 - 001	245X750	300X750	400X750	60	75	EN 1433: D400	DUCTILE IRON
CG-400X750-D400-AS-04 - 001	340X750	400X750	550X750	60	75	EN 1433: D400	DUCTILE IRON

SURFACE/VALVE BOXES

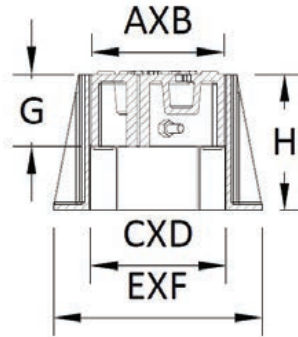
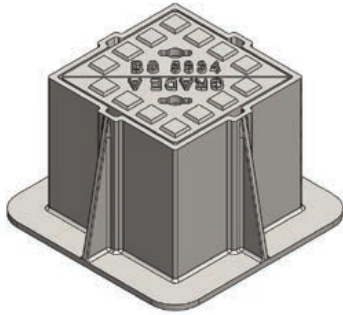

Features

- Double Triangular cover.
- Covers connected with SS bolt

Options

- Cover secured with SS chain.

Product code	CXD (mm)	AXB (mm)	EXF (mm)	G (mm)	H (mm)	Load class	Material Product code
SB-150X150 DT-A-AS-04 - 001	150X150	145X145	230X230	80	150	BS 5834 GRADE A	DUCTILE IRON
SB-250X250 DT-A-AS-04 - 001	250X250	245X245	350X350	70	100	BS 5834 GRADE A	DUCTILE IRON

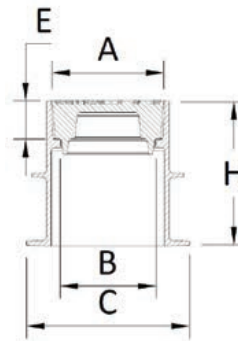
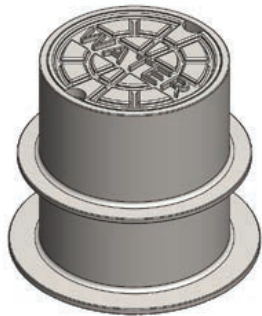

Options

- Cover secured with chain.
- Adjustable cover.

Product code	B Ø (mm)	A Ø (mm)	C Ø (mm)	E (mm)	H (mm)	Load class	Material Product code
VB-160-A-AS-01-001	160	185	270	185	240	BS 5834 GRADE A	GREY CAST IRON

SURFACE/VALVE BOXES

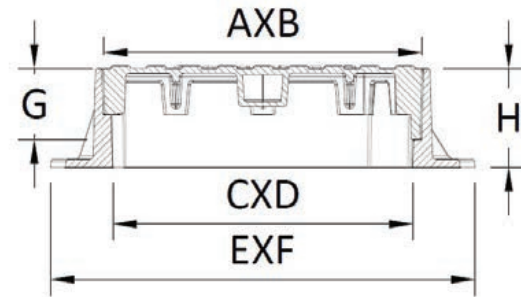
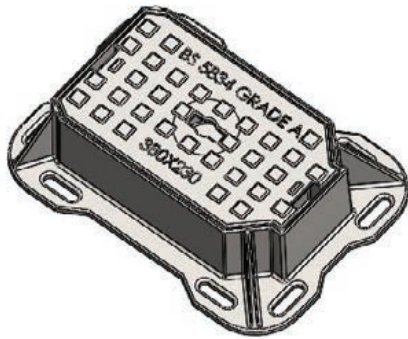

Features

- Wedge Seating.

Options

- Cover secured with SS chain.

Product code	CXD (mm)	AXB (mm)	EXF (mm)	G (mm)	H (mm)	Load class	Material Product code
SB-380X230-A-AS-04 - 001	380X230	402X232	535X385	90	125	BS5834 GRADE A	DUCTILE IRON
SB-250X250 -A-AS-04 - 001	250x250	280x280	450x450	60	100	BS5834 GRADE A	DUCTILE IRON

TREE GRATES

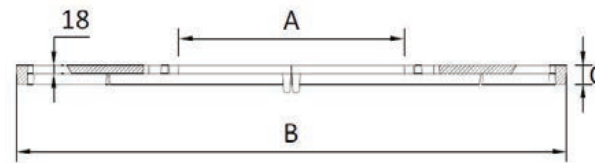

Features

- Tree grates in 4 pieces.
- Bolted Together

Options

- With mild steel frame

Product code	A(mm)	B (mm)	B (mm)	Material Product code
TG-500-AS-0000-04 - 001	500 DIA	1200X1200	45	DUCTILE IRON
TG-700-AS-0000-04 - 001	700 DIA	1400X1400	45	DUCTILE IRON
TG-600X600-AS-0000-04 - 001	600X600	1200X1200	45	DUCTILE IRON

ROOF & FLOOR DRAINS



OTHER POSSIBLE ENGINEERING PRODUCTS





مصنع سهيل للمصبوبات المعدنية
SUHAIL METAL CASTINGS FACTORY

SUHAIL

📍 Msheireb, Building T05, 5th Floor, P.O Box 8839, Doha, Qatar

☎ + 974 4427 5552

📞 +974 4427 5554

✉ info@suhailcastings.com

🌐 www.suhailcastings.com

**THE ONLY WAY TO
UNCOVER LIMITS IS
TO GO BEYOND THEM**

📱 📷 in 🐦 @suhailindustries